

SPECIFICATIONS SHEET

PRODUCT TYPE : EXTERNAL DRIVE PIEZO TRANSDUCER

PRODUCT SERIES : BSP122.5SM-25-GW-T/R

DESCRIPTION : PZ TRANSDUCER 5V SMD LCP RoHS SP

ADD " ICC BSP122.5 " " + " & " DATE CODE " MARKING

COLOR : BLACK

ELECTRICAL SPECIFICATIONS

<u>MODEL NO.</u>	<u>BSP122.5SM-25-GW-T/R</u>
<u>SOUND PRESSURE LEVEL</u>	80.0 dBA Min. (5.0 V p-p Square Wave , 10.0 cm , 4100 Hz)
<u>CAPACITANCE</u>	15000 pF ± 30 % at 1000 Hz
* <u>MAX. INPUT VOLTAGE</u>	25.0 V p-p
<u>OPERATING TEMPERATURE</u>	- 20.0 ~ + 70.0 ° C
<u>STORAGE TEMPERATURE</u>	- 30.0 ~ + 80.0 ° C
<u>TERMINAL</u>	SMD
<u>HOUSING MATERIAL</u>	LCP
* <u>WEIGHT</u>	0.5 g

DIMENSIONS

UNIT : mm
Tolerance : ± 0.5 mm

TOP VIEW

SIDE VIEW

BOTTOM VIEW

Recommended Foot Pattern

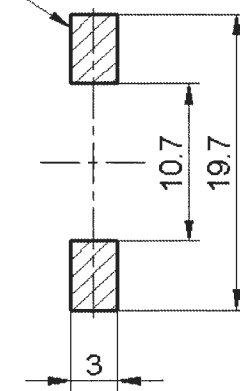
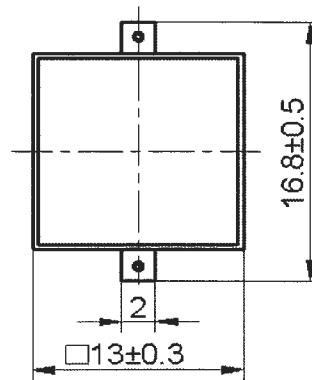
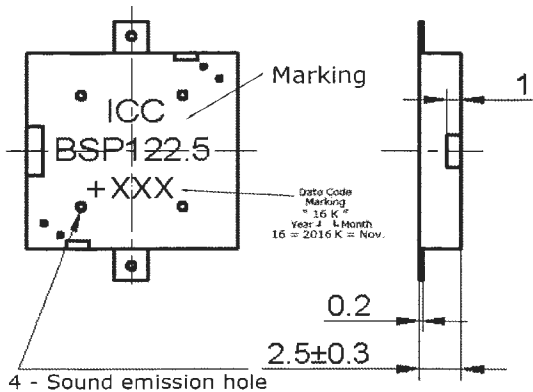

Approved By : LL
Date : 14-Dec.-2016

Prepared By : VC
Date : 14-Dec.-2016

Modify :	Date :	By :