

# INTERVOX Speakers from International C

215 McCormick Drive, Bohemia, NY 11716 (631) 952-9595 (631) 952-9597 www.icc107.com

1.	<b>MODEL:</b>	<b>SR800RMS</b>					
2.	Dimension	Outer Diameter	<b>20</b>	mm.	Baffle Opening	<b>18.7</b>	mm.
		Height	<b>Refer to Drawing</b>		Weight	<b>1.7</b>	Grams.
3.	Magnet	Materials	<b>Rare Earth</b>		Size	$\varnothing$ <b>6.5 x 1.5</b> mm.	
4.	Nominal Impedance	<b>8</b>		$\Omega$	$\pm$ <b>15</b>	%	At <b>1500</b> Hz.
5.	Power Rating	Normal	<b>100</b>	mW.	Maximum	<b>200</b>	mW.
6.	Lowest Resonant Frequency	<b>800</b>		$\pm$	<b>20</b>	%	Hz.
7.	Output Sound Pressure Level (S.P.L.)	<b>71</b>		$\pm$	<b>3</b>	db / 0.1 Watt · 0.5 Meter.	
		Average at	<b>1200,</b>	<b>1500,</b>	<b>2000,</b>	<b>2500</b>	Hz.
8.	Frequency Range	<b>500</b>	~	<b>5300</b>	Hz.	Average SPL - 10 db.	
9.	Distortion	<b>5</b>	%	Maximum	At <b>1000</b>	Hz.	<b>100</b> mW.
10.	Abnormal Sound Test	Must be Normal Tested By <b>0.9</b> Volts. Sine Wave.					
11.	Load Test	White Noise with Weighted Filter <b>0.9</b> Volts.(RMS) <b>24</b> Hrs.					
12.	Polarity	Diaphragm shall move Forward when Apply a Positive DC.					
		Current to the '+' or 'Marked' Terminal.					

## Mounting Notice

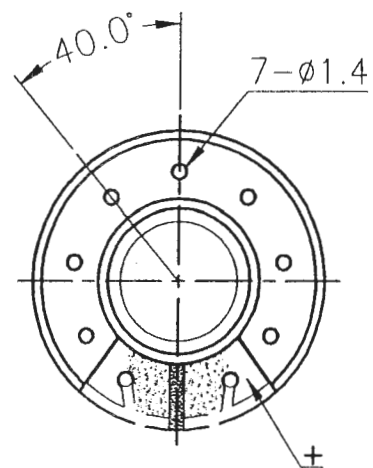
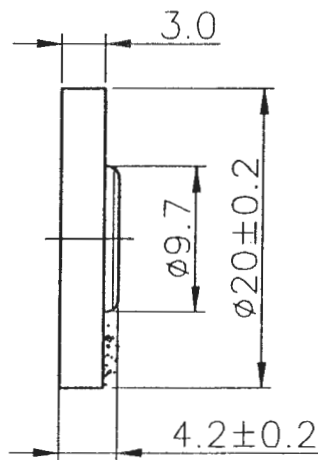
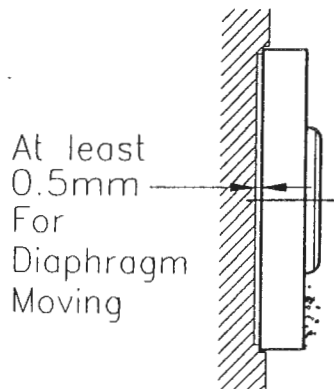

Unit : mm

Housing Material : ABS

SR800RMS Vol:0.894V(0.1W) Dis:0.5M  
X:1.0000kHz \*Y:74.50dB ZA:Live Curve SSR Fund.

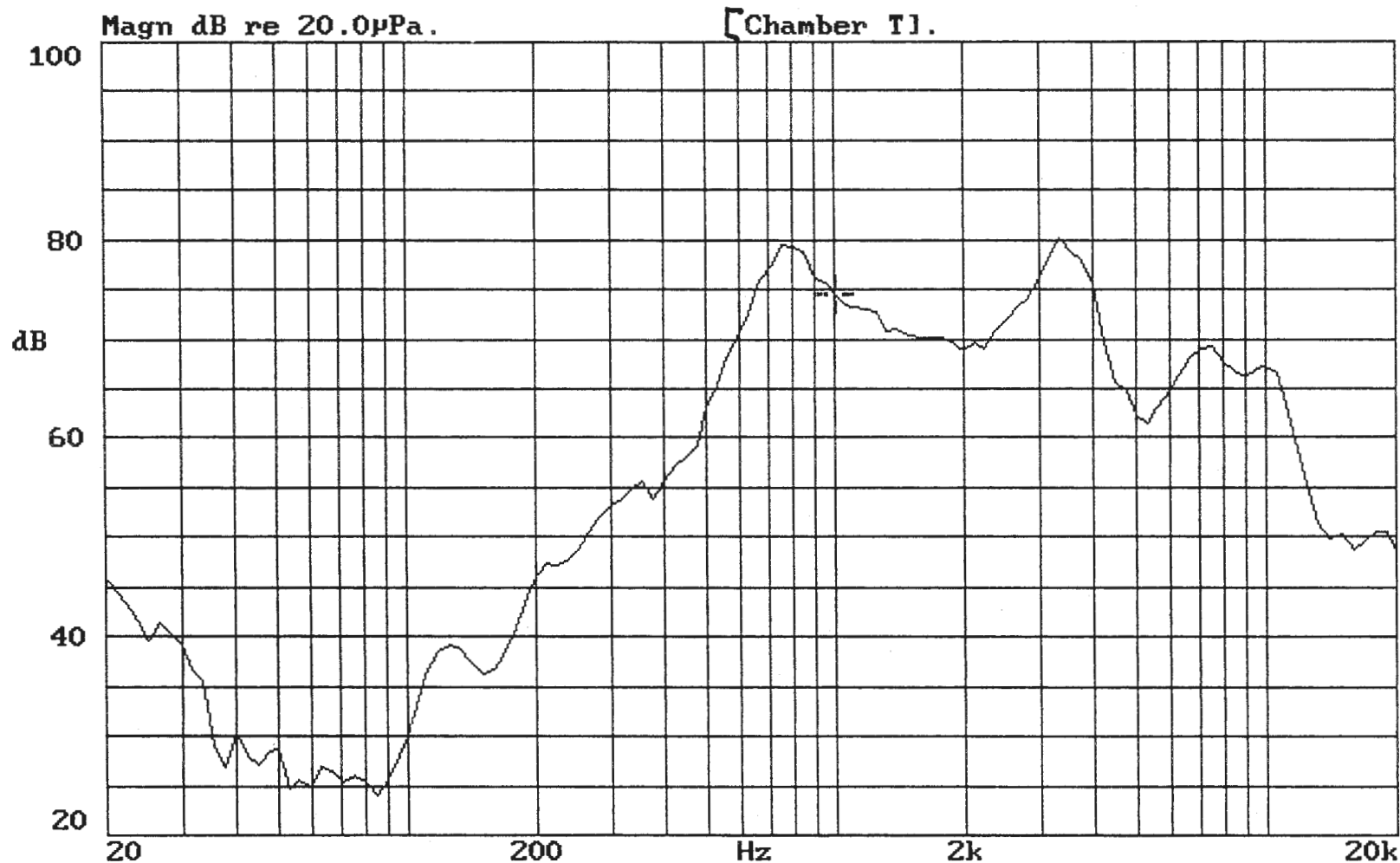

17-JUN-1999 08:46:56

Mode: SPEAKER

