

INTERVOX Speakers from International C

215 McCormick Drive, Bohemia, NY 11716 (631) 952-9595 (631) 952-9597 www.icc107.com

1.	MODEL:	SR800RS-M-1				
2.	Dimension	Outer Diameter	20	mm.	Baffle Opening ϕ 19	mm.
		Height	Refer to Drawing .		Weight	2.0 Grams.
3.	Magnet	Materials	Rare Earth		Size	ϕ 8.0x0.8 mm.
4.	Nominal Impedance	8	Ω	\pm 15 %	At	1500 Hz.
5.	Power Rating	Normal	500	mW.	Maximum	1000 mW.
6.	Lowest Resonant Frequency	650	\pm	20 %		Hz.
7.	Output Sound Pressure Level (S.P.L.)	78	\pm	3 db /	0.5 Watt	0.5 Meter.
		Average at				
8.	Frequency Range	400	~	20000	Hz.	Average S P L - 10 db.
9.	Distortion	5	%	Maximum At	1000 Hz.	500 mW.
10.	Abnormal Sound Test	Must Be Normal Test By 2.0 Volts. Sine Wave.				
11.	Load Test	White Noise With Weighted Filter 2.0 Volts.(RMS) 24 Hrs.				
12.	Polarity	Diaphragm shall move Forward when Apply a Positive DC.				
		Current to the "+" or "Marked" Terminal.				

MOUNTING NOTICE

At Least
0.5mm
For
Diaphragm
Moving

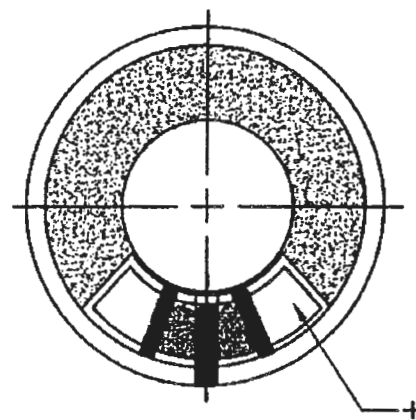
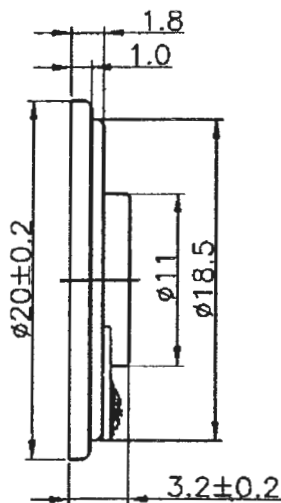
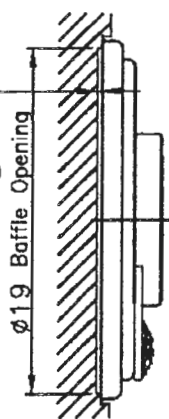

450

Unit : mm

Housing Material : METAL

INTERVOX Speakers from International ©

SR800RS-M-1

450

VOL:2.0V(0.5W) DIS:0.5M

X:1.000kHz

*Y:79.11dB

ZA:Live Curve

SSR Fund.

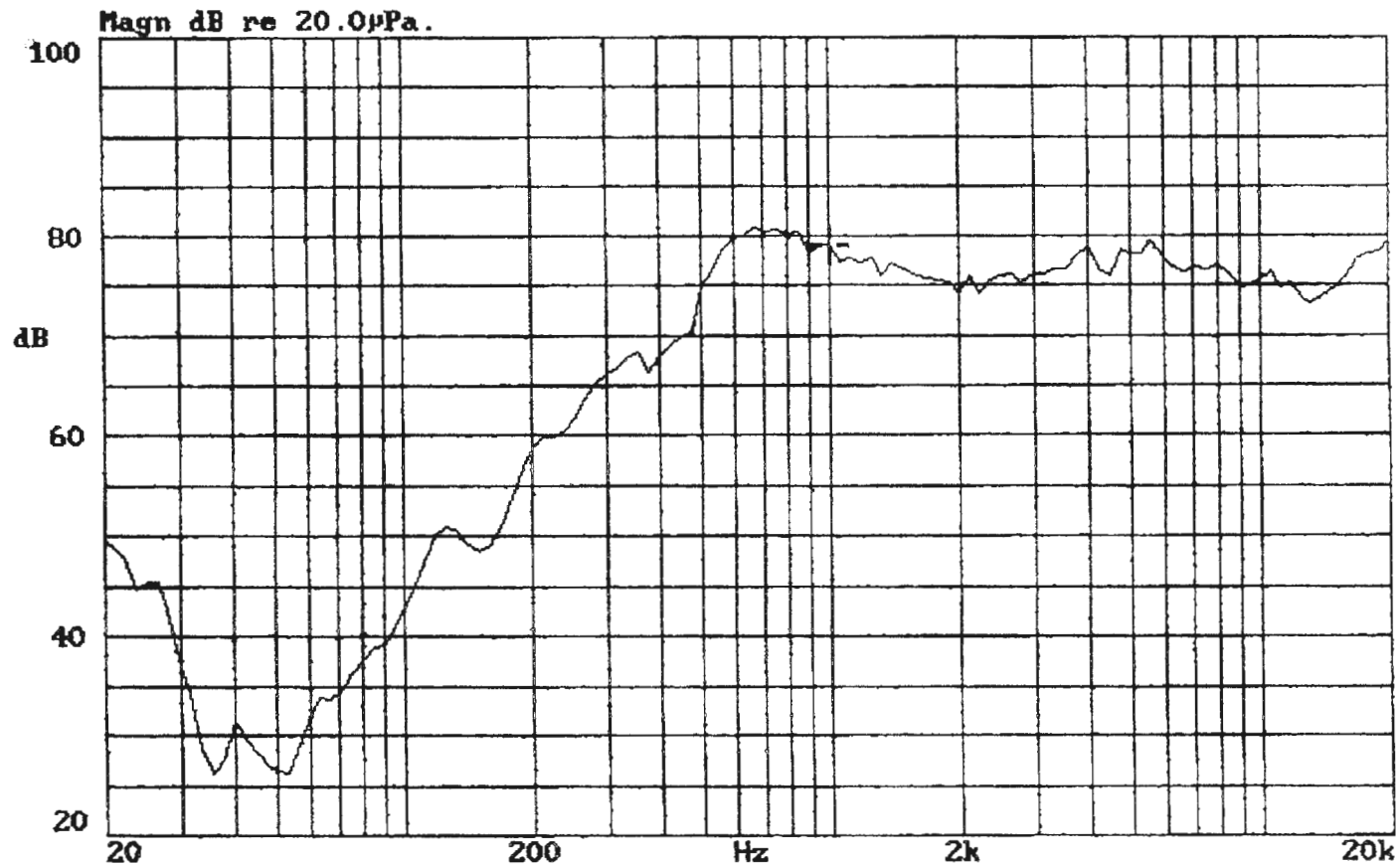

17-FEB-2000 15:01:40

Mode: SPEAKER

